

**Acknowledgment and
Notice of Acknowledgment
of Acceptance of R.S. 2477
Right-of-Way Grant**

Ent 103062 Bk 893 Pg 1-12
Date: 29-MAY-2008 10:34AM
Fee: None
Filed By: LCJ
LOUISE JONES, Recorder
SAN JUAN COUNTY CORPORATION
For: GOVERNOR STATE OF UTAH

THE STATE OF UTAH

TO ALL WHOM THESE PRESENTS SHALL COME, Greeting:

Know ye, This is an Acknowledgment and Notice of Acknowledgment made under Utah Code Sections 72-5-309 through 310 inclusive, that the grant of the United States of America of “the right of way for the construction of highways over public lands, not reserved for public uses” under United States Revised Statutes 2477 (43 U.S.C. Section 932 (repealed October 21, 1976, with proviso recognizing the validity of rights-of-way already established)) was accepted for and on behalf of the State of Utah and its political subdivision San Juan County as it pertains to the highway located in San Juan County known as LIGHTNING DRAW ROAD; County Road Number: B141; State Geographic Information Database (SGID) Road Identification Number: RD190082. Total road length is 2.11 miles more or less.

The reason for this Acknowledgment and Notice of Acknowledgment includes, but is not limited to, the fact that the road was constructed, mechanically, or by continuous use as a public highway for a period of at least ten years, over public lands not reserved for public uses, prior to the earlier of (a) the October 21, 1976 repeal of R.S. 2477 or (b) the date the servient estate was reserved for public uses.

This Acknowledgment and Notice of Acknowledgment applies only to the segments of the road that traverse land owned by the Bureau of Land Management, United States Department of the Interior, and does not apply to segments of the road that traverse land owned by any other person or entity. The State of Utah and its political subdivisions reserve the right to make further acknowledgments and notices of acknowledgment with regard to road segments that traverse land owned by other entities, including the United States of America, through one or more of its agencies.

A printed copy of a map showing the location of the road in said county is appended hereto as “Attachment 1,” a printed copy of representative photos of the road is appended hereto as “Attachment 2,” a printed copy of a description of the beginning and ending points of the entire road together with a list of Townships, Ranges and Sections that may be traversed by the road in said county is appended hereto as “Attachment 3,” and a printed copy of the Road Centerline Description Cover Page(s) is appended hereto as “Attachment 4.” The Appendices listed in “Attachment 4” that contain the actual road centerline descriptions are incorporated herein by reference. Affidavits provided by individuals familiar with the road are appended hereto as “Attachment 5.”

A printed copy of this Acknowledgment and Notice of Acknowledgment, together with its Attachments and Appendices, may be viewed and/or obtained at the office of the Utah State Archives.

An electronic copy of this Acknowledgment and Notice of Acknowledgment, together with its Attachments and Appendices, may be viewed and/or downloaded as read-only PDF (Portable Document Format) files via the

Internet at <http://recorded2477roads.utah.gov>.

The owner of the servient estate in the land underlying the road-segments subject to this Acknowledgment and Notice is believed to be the United States of America through one or more of its agencies. Any of such agencies or any other person with a servient ownership claim or a competing dominant estate right-of-way ownership claim, may file a petition in the State District Court for Salt Lake County for a decision regarding the correctness of this Acknowledgment. A claimant shall file a petition within sixty (60) days after receipt of this Notice.

In Witness Whereof, I, John Harja, the official designee of the Governor of the State of Utah, in conformity to the laws of the State (Utah Code Sections 72-5-308 through 310 inclusive), have caused this Acknowledgment and Notice of Acknowledgment to be made.

Signed by my hand in Salt Lake City, Utah, the 22nd day of MAY, 2008.

By the Governor's Designee



John Harja

CERTIFICATION

State of Utah)
 : ss
County of Salt Lake)

I hereby certify that the signer of the foregoing document, John Harja, is personally known by me, has made a voluntary signature and taken an oath stating that he is the official designee of the Governor of the State of Utah and is authorized to sign this document on the Governor's behalf pursuant to Utah Code Section 72-5-309. He further vouched that, based upon information and belief, the facts alleged therein are true.

Dated this 22nd day of May, 2008.



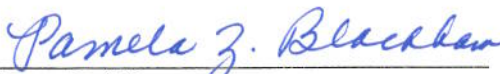

Notary Public





1:22,760
1 inch equals 0.4 miles



LIGHTNING DRAW ROAD - San Juan County
SGID RD_ID RD190082

Land Ownership Categories

- BLM
- Private
- SITLA, State Trust Land
- USFS, National Forest
- State Parks and Recreation
- Tribal, Indian Reservation
- NPS, National Park

Transportation Network

- LIGHTNING DRAW ROAD
- Other Roads
- Title V, Issued Or Under Consideration By BLM Or County
- Photo Event Point

Section = 1 Mile

Map prepared by the State of Utah
Natural Resources Center
Room 5130 State Office Building
Salt Lake City, Utah 84114
Apr 02, 2008





EP190082001



EP190082003



EP190082004



EP190082006

EP000000000

EP000000000

LIGHTNING DRAW ROAD - San Juan County
SGID RD_ID RD190082

Map prepared by the State of Utah
Automated Geographic Reference Center
Room 5130 State Office Building
Salt Lake City, Utah 84114
April 11, 2008



Attachment 3

Beginning & Ending Points and Township, Range, and Section References For:

Popular Name: LIGHTNING DRAW ROAD

County: San Juan

County Road Number: B141

State Geographic Information Database (SGID) Road Identification Number: RD190082.

Total Road Length: 2.11 miles more or less.

Beginning at a point on the road centerline located at 38 degrees 05 minutes 52.74 seconds North Latitude and -109 degrees 23 minutes 36.31 seconds West Longitude, which can be converted to mapping accuracy State Plane Utah South Zone NAD 83 feet coordinates of X = 2,246,576.2 feet and Y = 10,370,503.2 feet based on the US Survey Foot conversion.

Ending at a point on the road centerline located at 38 degrees 06 minutes 57.64 seconds North Latitude and -109 degrees 21 minutes 55.62 seconds West Longitude, which can be converted to mapping accuracy State Plane Utah South Zone NAD 83 feet coordinates of X = 2,254,473.1 feet and Y = 10,377,248.7 feet based on the US Survey Foot conversion.

This road may traverse:

Township 31 South Range 23 East, Section(s) 2,3,9,10, Salt Lake Base & Meridian
See Attachment 1 above for a cartographic depiction of the course of this road.

**Attachment 4
Road Centerline Description Cover Page(s)**

Popular Name: LIGHTNING DRAW ROAD

County: San Juan

County Road Number: B141

State Geographic Information Database (SGID) Road Identification Number: RD190082.

Total Road Length: 2.11 miles more or less.

Centerline Descriptions Of Road-Segments That Cross Over Federally Owned Land, Derived From Global Positioning System Data And Cross-checked against USGS Digital Orthophoto Quadrangles Compiled By The Utah Automated Geographic Reference Center And Entered Into The State Geographic Information Database (SGID).

Road-Segments Listed by SGID Road Identification Number (RD ID)	Road-Segment Numbers	Believed Ownership Of Servient Estate	Approximate Segment Length	See Attached Appendix
RD190082	001	BLM	1.56 Miles	A
RD190082	002	ST	0.55 Miles	(not shown)
		Total Road Length	2.11	_____

* Indicates that a Title V permit will be requested, is in process, or has been issued.

† Indicates that road-segments crossing Forest Service land are under consideration by the state and county as of the date of this Acknowledgment and Notice of Acknowledgment.

AFFIDAVIT OF LYNN L. ADAMS

LIGHTNING DRAW ROAD

SAN JUAN COUNTY, UTAH

COUNTY ROAD NUMBER B141

State of Utah)
 : ss
County of San Juan)

Lynn L. Adams, being first duly sworn, deposes and states as follows:

1. I am an adult competent to testify about the matters set forth below based upon my personal knowledge. I currently reside in San Juan County, Utah. I have lived in San Juan County for 82 years. I worked for the San Juan County Roads Department from 1961 to 1987.

2. I have traveled and am familiar with a road in San Juan County known as Lightning Draw Road. I am also familiar with the land the road traverses. When I first used and observed the road in 1938, it followed the same route as in 2007, when I last observed it. Attached is a San Juan County map showing Lightning Draw Road. To the best of my knowledge and based upon my use of and familiarity with this road and the land it traverses, the location and route of the road are correctly illustrated on the attached map.

3. I am informed that the County identifies this road according to the road number described above.

4. I have observed that the road has been open to the public for all to use, to come and go as they pleased, since at least as early as 1938 and continuing through 1976 to 2007. Throughout this time period I have observed travel on the road by various means, including: car, truck, pickup, motorcycle, and ATV. Throughout this time period, the road has been used

weekly, weather permitting, for more than 10 continuous years prior to 1976 and was used weekly, weather permitting, in 2007.

5. Throughout the time period from 1938 to 2007, I have used the road myself for the following uses: livestock operations and maintenance activities.

6. Throughout the time period described in the previous paragraph, I observed vehicles using the road at various times for the uses described in the previous paragraph, plus the following uses: hunting, tourism, mineral prospecting, wood gathering, recreation, and oil and gas exploration.

7. It is also the reputation in the community that this road has been open to the public for all to use, to come and go as they pleased, since at least as early as the early 1900s and continuing through 1976 to the present, for the uses described in the previous paragraphs.

8. I personally performed maintenance activities prior to 1976.

Dated this 17 day of September, 2007.

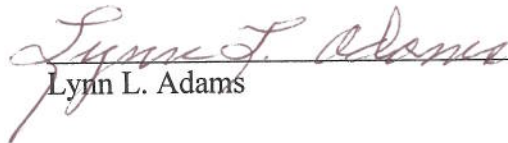
Lynn L. Adams

SUBSCRIBED AND SWORN TO before me this 17th day of September, 2007.

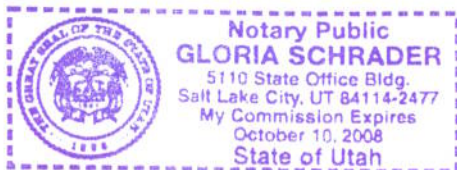

Notary Public

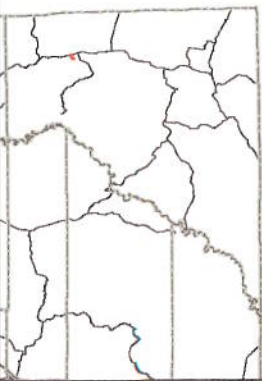

LIGHTNING DRAW
County Unique - B141

- Land Ownership Categories**
- BLM
 - National Recreation Area
 - SITLA, State Trust Land
 - USFS, National Forest
 - National Parks & Monuments (NPS)
- Misc**
- City / Town
 - Municipalities
 - Section = 1 Mile
- Transportation Network**
- LIGHTNING DRAW
 - State / U.S. Highway
 - Local Roads

 1:21,714
 1 inch equals 0.3 miles
 Jul 25, 2007

AFFIDAVIT OF TED C. BRONSON

LIGHTNING DRAW ROAD

SAN JUAN COUNTY, UTAH

COUNTY ROAD NUMBER B141

State of Utah)
 : ss
County of San Juan)

Ted C. Bronson, being first duly sworn, deposes and states as follows:

1. I am an adult competent to testify about the matters set forth below based upon my personal knowledge. I currently reside in San Juan County, Utah. I have lived in San Juan County 81 years. I worked as a grader for the San Juan County Road Department during the years 1961-1987.

2. I have traveled and am familiar with a road in San Juan County known as Lightning Draw Road. I am also familiar with the land the road traverses. When I first used and observed the road in the early 1960's, it followed the same route as in the late 1980s, when I last observed it. Attached is a San Juan County map showing Lightning Draw Road. To the best of my knowledge and based upon my use of and familiarity with this road and the land it traverses, the location and route of the road are correctly illustrated on the attached map.

3. I am informed that the County identifies this road according to the road number described above.

4. I have observed that the road has been open to the public for all to use, to come and go as they pleased, since at least as early as the early 1960's and continuing through 1976 to the late 1980s. Throughout this time period I have observed travel on the road by various

means, including horses, maintenance vehicles, cars and trucks. Throughout this time period, the road has been used weekly.

5. Throughout the time period from the early 1960's to the late 1980s, I have used the road myself for the following uses: hunting, county road maintenance and traveling in and through the area.

6. Throughout the time period described in the previous paragraph, I observed vehicles using the road at various times for the uses described in the previous paragraph, plus the following uses: livestock operations.

7. It is also the reputation in the community that this road has been open to the public for all to use, to come and go as they pleased, since at least as early as sometime before the early 1950s and continuing through 1976 to the present, for the uses described in the previous paragraphs.

8. I personally graded the road from 1974 to the early 1980's as well as observed the following evidence of construction and maintenance performed on the road prior to 1976: road berms, cuts and fills, constructed dugways and culverts from at least as early as the early 1970s.

Dated this 17 day of September, 2007.



Ted C. Bronson

SUBSCRIBED AND SWORN TO before me this 17th day of September, 2007.

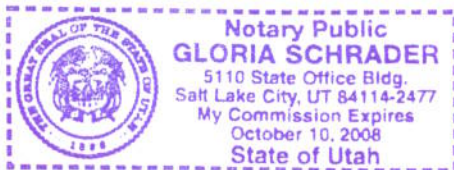



Notary Public

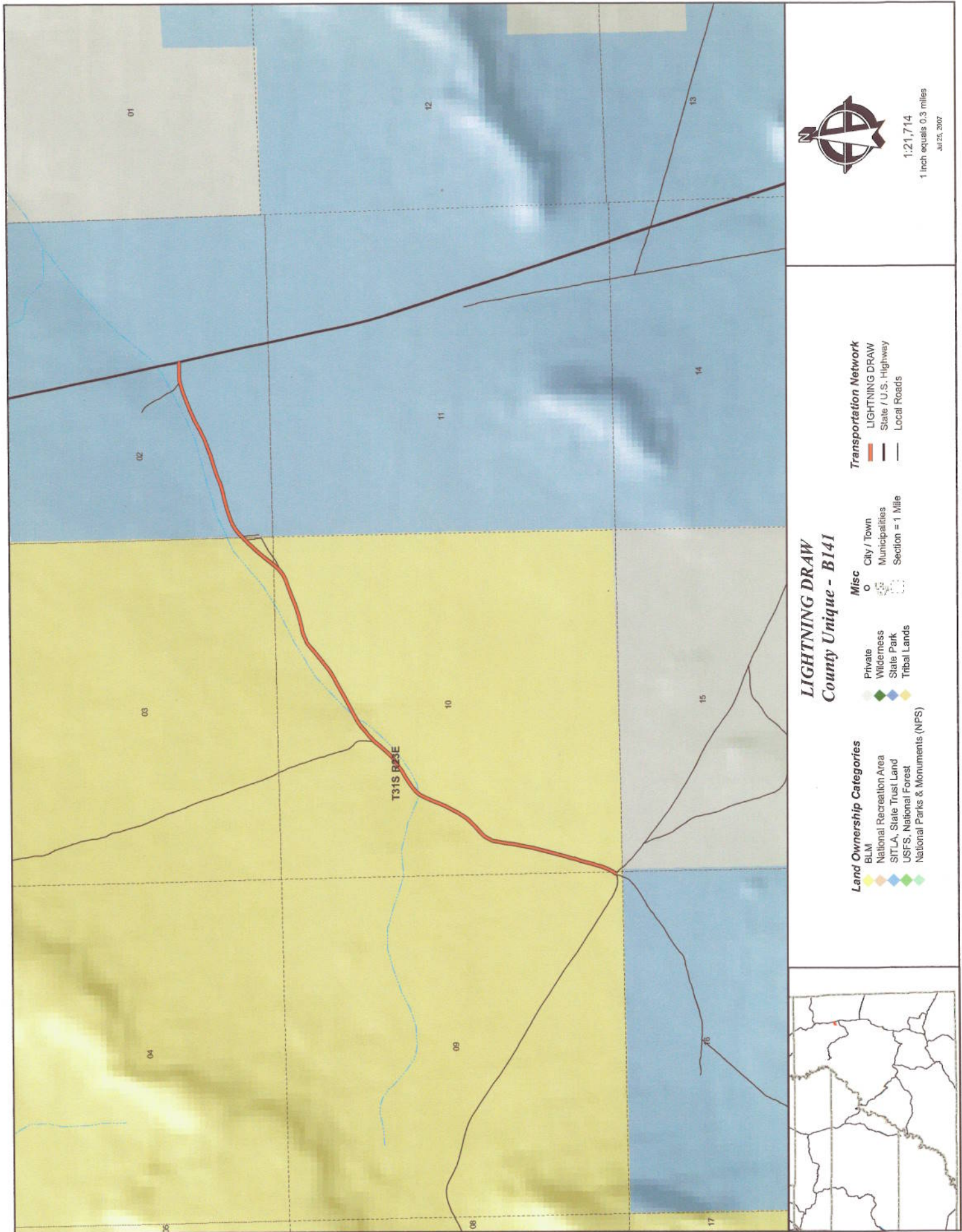

Appendix A to Attachment 4

Popular Name: LIGHTNING DRAW ROAD

County: San Juan

County Road Number: B141

State Geographic Information Database (SGID) Road Identification Number: RD190082.

Road-Segment Number: 001

Road-Segment Length: 1.56 miles more or less.

Believed owner of the land underlying this road-segment is: Bureau of Land Management.

The following description is based upon the geographic coordinate system using the NAD83 Datum. The source is GPS mapping grade data as indicated in the metadata and/or the transportation data model of the State of Utah Geographic Information Database (SGID).

The road-segment itself is the monument that is identified by its physical presence on the land. The location of said physical presence is closely approximated by mapping grade Global Positioning System (GPS) data. Said data are checked against the corresponding gray-scale 1-meter Digital Orthophoto Quadrangles published by the United States Geological Survey (USGS) to verify a reasonable degree of accuracy. In circumstances where accurate satellite signal acquisition is not possible, such as deep, narrow canyons or under a canopy of dense foliage, or where very sharp curves in the road make accuracy questionable, such portions of the road were digitized from the corresponding gray-scale 1-meter Digital Orthophoto Quadrangles published by the United States Geological Survey (USGS).

This road-segment may traverse:

Township 31 South Range 23 East, Section(s) 2,3,9,10, Salt Lake Base & Meridian

The following description closely approximates the location of the centerline of the physical monument (LIGHTNING DRAW ROAD)-- Segment 001 based on mapping grade Global Positioning System (GPS) data as defined above:

Beginning at a point on the road center line located at 38 degrees 05 minutes 52.74 seconds North Latitude and -109 degrees 23 minutes 36.31 seconds West Longitude, which can be converted to mapping accuracy State Plane Utah South Zone NAD 83 feet coordinates of X = 2,246,576.2 feet and Y = 10,370,503.2 feet; thence the following courses along the said road center line:

thence North 07 Degrees 04 Minutes 28 Seconds East	28.1 feet
thence North 34 Degrees 57 Minutes 49 Seconds East	39.8 feet
thence North 27 Degrees 36 Minutes 55 Seconds East	56.1 feet
thence North 23 Degrees 43 Minutes 15 Seconds East	66.1 feet
thence North 20 Degrees 35 Minutes 23 Seconds East	72.7 feet
thence North 17 Degrees 15 Minutes 39 Seconds East	81.6 feet
thence North 15 Degrees 29 Minutes 27 Seconds East	83.2 feet
thence North 14 Degrees 46 Minutes 39 Seconds East	83.3 feet
thence North 15 Degrees 09 Minutes 43 Seconds East	80 feet
thence North 15 Degrees 59 Minutes 41 Seconds East	44.4 feet
thence North 22 Degrees 32 Minutes 04 Seconds East	6.8 feet

thence North 14 Degrees 26 Minutes 39 Seconds East 6.4 feet
 thence North 15 Degrees 38 Minutes 46 Seconds East 40.6 feet
 thence North 15 Degrees 27 Minutes 54 Seconds East 71.3 feet
 thence North 14 Degrees 47 Minutes 32 Seconds East 90.7 feet
 thence North 14 Degrees 52 Minutes 13 Seconds East 96.6 feet
 thence North 15 Degrees 29 Minutes 48 Seconds East 103.7 feet
 thence North 14 Degrees 38 Minutes 37 Seconds East 105.6 feet
 thence North 13 Degrees 10 Minutes 06 Seconds East 104.3 feet
 thence North 12 Degrees 40 Minutes 54 Seconds East 103.7 feet
 thence North 10 Degrees 54 Minutes 12 Seconds East 103 feet
 thence North 10 Degrees 58 Minutes 31 Seconds East 104.1 feet
 thence North 10 Degrees 39 Minutes 17 Seconds East 103.6 feet
 thence North 09 Degrees 11 Minutes 32 Seconds East 105.5 feet
 thence North 09 Degrees 09 Minutes 47 Seconds East 109.8 feet
 thence North 12 Degrees 11 Minutes 24 Seconds East 103.2 feet
 thence North 20 Degrees 30 Minutes 43 Seconds East 77.6 feet
 thence North 32 Degrees 07 Minutes 51 Seconds East 70.4 feet
 thence North 41 Degrees 18 Minutes 44 Seconds East 70.7 feet
 thence North 48 Degrees 07 Minutes 51 Seconds East 73.7 feet
 thence North 49 Degrees 26 Minutes 59 Seconds East 75.7 feet
 thence North 46 Degrees 40 Minutes 33 Seconds East 67.3 feet
 thence North 41 Degrees 46 Minutes 24 Seconds East 81.8 feet
 thence North 36 Degrees 14 Minutes 52 Seconds East 93.1 feet
 thence North 31 Degrees 22 Minutes 22 Seconds East 95.6 feet
 thence North 29 Degrees 28 Minutes 09 Seconds East 99.8 feet
 thence North 26 Degrees 44 Minutes 05 Seconds East 107.6 feet
 thence North 24 Degrees 19 Minutes 04 Seconds East 107.9 feet
 thence North 22 Degrees 26 Minutes 07 Seconds East 101 feet
 thence North 20 Degrees 41 Minutes 29 Seconds East 86.1 feet
 thence North 24 Degrees 54 Minutes 55 Seconds East 74.7 feet
 thence North 32 Degrees 06 Minutes 34 Seconds East 69.2 feet
 thence North 40 Degrees 51 Minutes 36 Seconds East 65.8 feet
 thence North 47 Degrees 22 Minutes 07 Seconds East 64.8 feet
 thence North 51 Degrees 22 Minutes 38 Seconds East 69.8 feet
 thence North 54 Degrees 59 Minutes 25 Seconds East 76.6 feet
 thence North 57 Degrees 59 Minutes 16 Seconds East 81.8 feet
 thence North 58 Degrees 58 Minutes 14 Seconds East 82.8 feet
 thence North 58 Degrees 08 Minutes 02 Seconds East 90.9 feet
 thence North 55 Degrees 16 Minutes 35 Seconds East 92.3 feet
 thence North 51 Degrees 44 Minutes 00 Seconds East 89.1 feet
 thence North 47 Degrees 09 Minutes 02 Seconds East 86.9 feet
 thence North 41 Degrees 16 Minutes 47 Seconds East 85.5 feet
 thence North 39 Degrees 47 Minutes 34 Seconds East 84.1 feet
 thence North 40 Degrees 19 Minutes 37 Seconds East 82.1 feet
 thence North 42 Degrees 26 Minutes 17 Seconds East 76.4 feet
 thence North 45 Degrees 49 Minutes 54 Seconds East 70.5 feet
 thence North 48 Degrees 39 Minutes 30 Seconds East 74 feet
 thence North 49 Degrees 44 Minutes 36 Seconds East 79.2 feet
 thence North 53 Degrees 29 Minutes 41 Seconds East 85 feet

thence North 57 Degrees 23 Minutes 18 Seconds East 90.8 feet
 thence North 61 Degrees 12 Minutes 01 Seconds East 95.6 feet
 thence North 61 Degrees 29 Minutes 15 Seconds East 102 feet
 thence North 61 Degrees 38 Minutes 56 Seconds East 107.5 feet
 thence North 61 Degrees 24 Minutes 01 Seconds East 116.3 feet
 thence North 61 Degrees 25 Minutes 18 Seconds East 117.7 feet
 thence North 62 Degrees 32 Minutes 51 Seconds East 114.3 feet
 thence North 60 Degrees 04 Minutes 59 Seconds East 110.2 feet
 thence North 56 Degrees 21 Minutes 09 Seconds East 106.8 feet
 thence North 53 Degrees 10 Minutes 38 Seconds East 108.6 feet
 thence North 50 Degrees 50 Minutes 39 Seconds East 119.2 feet
 thence North 50 Degrees 56 Minutes 28 Seconds East 117.4 feet
 thence North 50 Degrees 31 Minutes 20 Seconds East 107.5 feet
 thence North 52 Degrees 58 Minutes 37 Seconds East 77.4 feet
 thence North 61 Degrees 04 Minutes 03 Seconds East 65 feet
 thence North 68 Degrees 24 Minutes 13 Seconds East 62.3 feet
 thence North 73 Degrees 31 Minutes 14 Seconds East 65.9 feet
 thence North 75 Degrees 39 Minutes 53 Seconds East 70.3 feet
 thence North 76 Degrees 21 Minutes 42 Seconds East 65.4 feet
 thence North 75 Degrees 49 Minutes 53 Seconds East 54.8 feet
 thence North 77 Degrees 29 Minutes 31 Seconds East 57.4 feet
 thence North 73 Degrees 36 Minutes 18 Seconds East 68.6 feet
 thence North 71 Degrees 51 Minutes 39 Seconds East 90 feet
 thence North 69 Degrees 31 Minutes 12 Seconds East 105.6 feet
 thence North 69 Degrees 38 Minutes 50 Seconds East 113.9 feet
 thence North 69 Degrees 37 Minutes 57 Seconds East 112.8 feet
 thence North 69 Degrees 00 Minutes 48 Seconds East 100.3 feet
 thence North 63 Degrees 47 Minutes 02 Seconds East 90.8 feet
 thence North 53 Degrees 25 Minutes 28 Seconds East 88.7 feet
 thence North 45 Degrees 15 Minutes 46 Seconds East 94.7 feet
 thence North 39 Degrees 55 Minutes 01 Seconds East 27 feet
 thence North 39 Degrees 53 Minutes 03 Seconds East 72.7 feet
 thence North 39 Degrees 02 Minutes 38 Seconds East 98.9 feet
 thence North 39 Degrees 21 Minutes 29 Seconds East 97.2 feet
 thence North 41 Degrees 29 Minutes 20 Seconds East 91.1 feet
 thence North 42 Degrees 36 Minutes 14 Seconds East 82.4 feet
 thence North 43 Degrees 44 Minutes 12 Seconds East 68.9 feet
 thence North 45 Degrees 20 Minutes 24 Seconds East 62.4 feet
 thence North 49 Degrees 01 Minutes 01 Seconds East 12.3 feet
 thence North 44 Degrees 22 Minutes 32 Seconds East 40.8 feet
 thence North 47 Degrees 16 Minutes 10 Seconds East 8.8 feet

more or less to **the ending point**
at: 38 degrees 06 minutes 48.59 seconds North Latitude and -109 degrees 22 minutes 29.82 seconds West
 Longitude, which can be converted to mapping accuracy State Plane Utah South Zone NAD 83 feet
 coordinates of X = 2,251,761.9 feet and Y = 10,376,271.6 feet.

Attachment 5